

Can Am Defender Bed Box Mounting Kit

Product Instructions | Part No: 53501

Before you begin, read these instructions and check to be sure all parts and tools are accounted for. Please retain these instructions for future reference and part ordering information. Note: If any hardware is missing, do not return to the store. Call us to help, toll free at 1-877-956-5746.

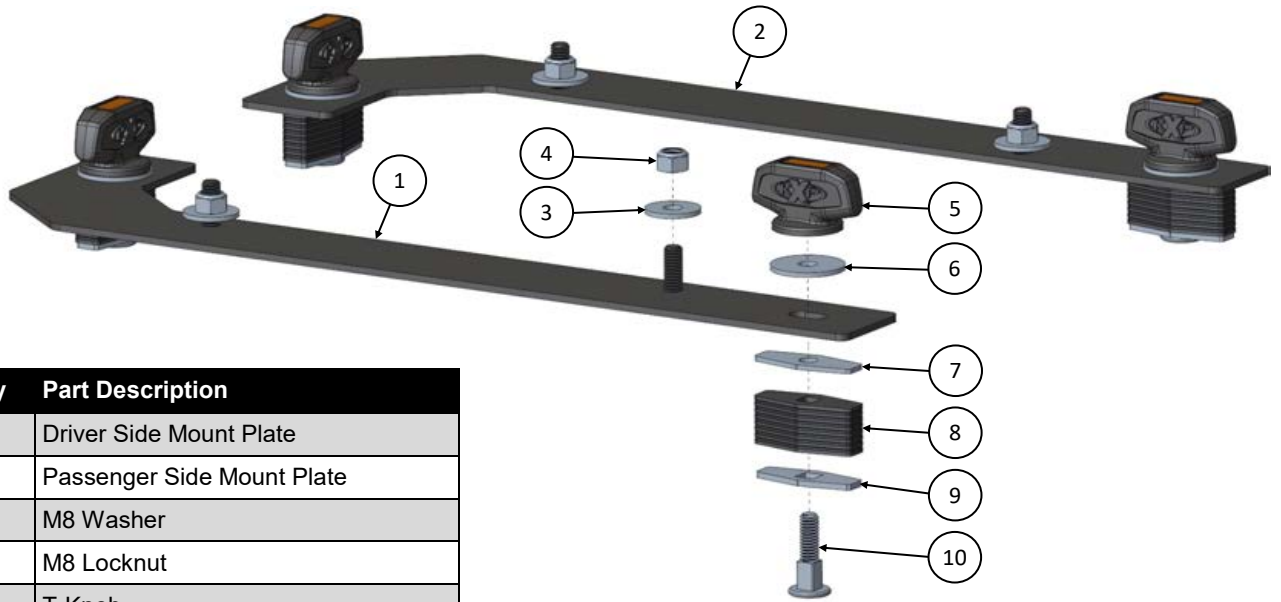

Item	Qty	Part Description
1	1	Driver Side Mount Plate
2	1	Passenger Side Mount Plate
3	4	M8 Washer
4	4	M8 Locknut
5	4	T-Knob
6	4	T-Knob Washer
7	4	Upper Metal Bushing Plate
8	4	Rubber Bushing
9	4	Lower Metal Bushing Plate
10	4	Threaded Post

TOOLS REQUIRED

- 13mm Wrench or Socket

MOUNTING INSTRUCTIONS:

1. Attach the LinQ Anchors [Items 5 thru 10] to the Driver and Passenger Side Mount Plates. See Illustration 1-1.



Kolpin Outdoors, Inc. | 9955 59th Ave N | Plymouth, MN 55442

(877) 956-5746 or (763) 478-5800 | kolpin.com | customerservice@kolpin.com

2. Assemble the Driver and Passenger Side Mount Plates to the bed rails by inserting the LinQ Anchors into the LinQ holes as shown. Downward pressure may need to be applied to insert the Rubber Bushings into the LinQ holes. See Illustration 1-2.
3. Remove the plastic thread caps from the threads on the Driver and Passenger Side Mount Plates.
4. Carefully place the 53470 Aluminum Bed Box (sold separately) onto male threads of the Driver and Passenger Side Mount Plates. Use the mounting holes in Aluminum Bed Box as shown. See Illustration 1-3.
5. Assemble the (4) M8 Washers and (4) M8 Locknuts onto the male threads of the Driver and Passenger Side Mount Plates. See Illustration 1-3.
6. Align and center Aluminum Bed Box to the Defender's bed.
7. While holding the Driver and Passenger Side Mount Plates firmly against the Defender bed rails, tighten the (4) T-Knobs.

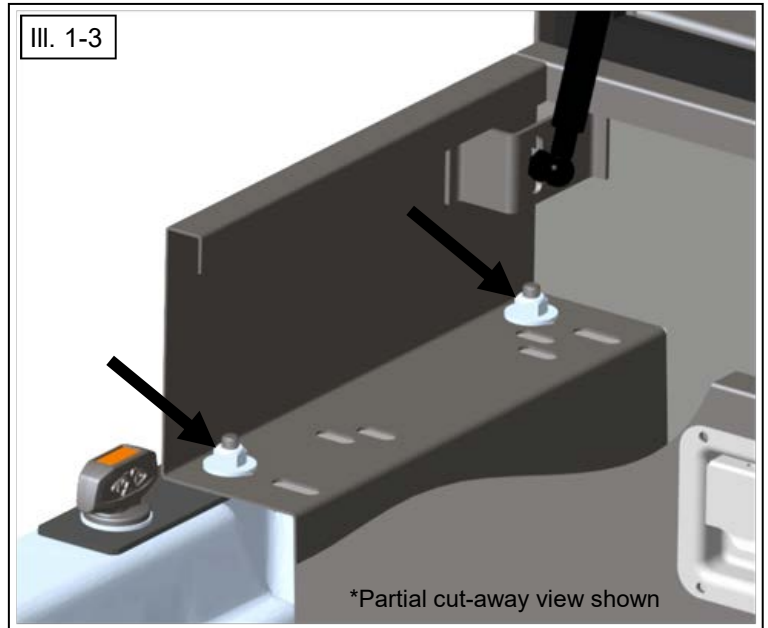
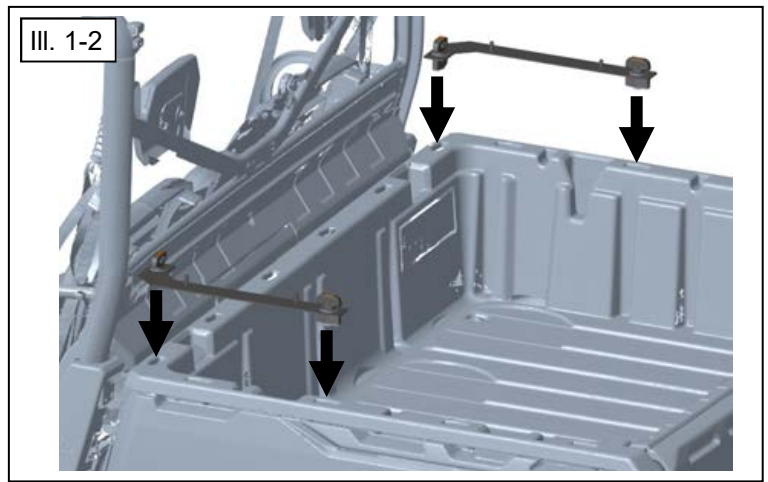

8. Tighten the (4) M8 Locknuts.

Use and Care Information:

- Check the accessory mounts frequently and retighten if necessary.
- When this accessory becomes dirty, rinse thoroughly with cool water to remove loose dirt, then wipe with a clean cloth or sponge.
- Never use petroleum solvents such as gasoline, thinner, benzene, acid or alkaline cleaners.

For additional assistance, please contact Kolpin customer service department at (877) 956-5746 or (763) 478-5800 or email customerservice@kolpin.com

One Year Limited Warranty

For the period of one (1) year from the purchase date, Kolpin will replace for the original purchaser, free of charge, any part or parts found upon examination by Kolpin to be defective in material, workmanship, or both.

All transportation costs incurred submitting product to Kolpin for warranty consideration must be borne by the purchaser. If Kolpin determines that the product must be returned to the factory for credit, please call 1-877-956-5746 for a Return Merchandise Authorization (RMA) number and shipping instructions.

This warranty does not apply to parts that have been damaged by accident, alteration, abuse, improper maintenance, normal wear, or other causes beyond the manufacturer's control. In order to protect you and your ATV, certain parts of the accessory system and/or hardware are designed to fail when the equipment is over-stressed. Parts that are lost due to loosening and improper maintenance are not covered under warranty. This warranty does not cover removal or reinstallation labor fees of the accessory system and related components. Most hardware is general in nature and is easily obtained locally. Be sure to replace with minimum metric class 8.8 specification.

Can-Am®, LinQ®, and Defender® are registered trademarks of Bombardier Recreational Products Inc.,